

Belt Misalignment Detector

BM-3 Smart Drift

The BM3 Smart Drift is designed to prevent the conveyor belt from drifting too far which could cause damage to the belt. When the conveyor belt drifts during start-up, or heavy load conditions, the edge of the belt will press against the BM-3 roller and cause, first a warning contact to operate at 10 ° and finally a trip contact to operate at 20°.

The BM-3 is made from extremely robust material. High Impact Glass Reinforced Nylon offers superior Thermal and UV resistance, Low water absorption, and a low environmental impact. It displays extremely good impact strength and dimensional stability.

All components of the BM-3 are made from non corrosive materials, such as Stainless, Brass, or Nylon.

The BM-3 Roller has a new weight distribution design that prevents whiplash strain on the the roller arm. Capable of running at 22000 rpm this roller is suitable to be used on conveyors running at extremely high speeds.



TECHNICAL SPECS

Material	GFPA60BLK & Stainless
Material Mounting Bracket	Stainless
IP Rating	IP66/67
Contacts (Alarm)	SPDT
Contacts (Trip)	SPDT
Alarm Angle	10°
Trip Angle	20°
Contact Rating	3A @ 250VAC
Terminal Sizes	Up to 2,5mm ² Wire
Approved Safety Standards of Contacts	VDE (EN6058-1)
Switch Certifications	ENEC / UL Certified in accordance with: EN 61058-1:2016 EN IEC 61058-1:2018 UL 61058-1 UL60158-1-1 CSA C22.2 NO.61058-1-17 CSA C22.2 NO.61058-1-1-17



IP66/67 RATING



RoHS COMPLIANT



DURABILITY



CHEMICAL RESISTANT



CORROSION RESISTANT



VIBRATION RESISTANT



UV RESISTANT



EASY TO INSTALL



SPACIOUS COMPARTMENT



IMPACT RESISTANT

Belt Misalignment Detector

BM-3 Smart Drift

A CLOSER LOOK AT THE BM-3 ON THE OUTSIDE

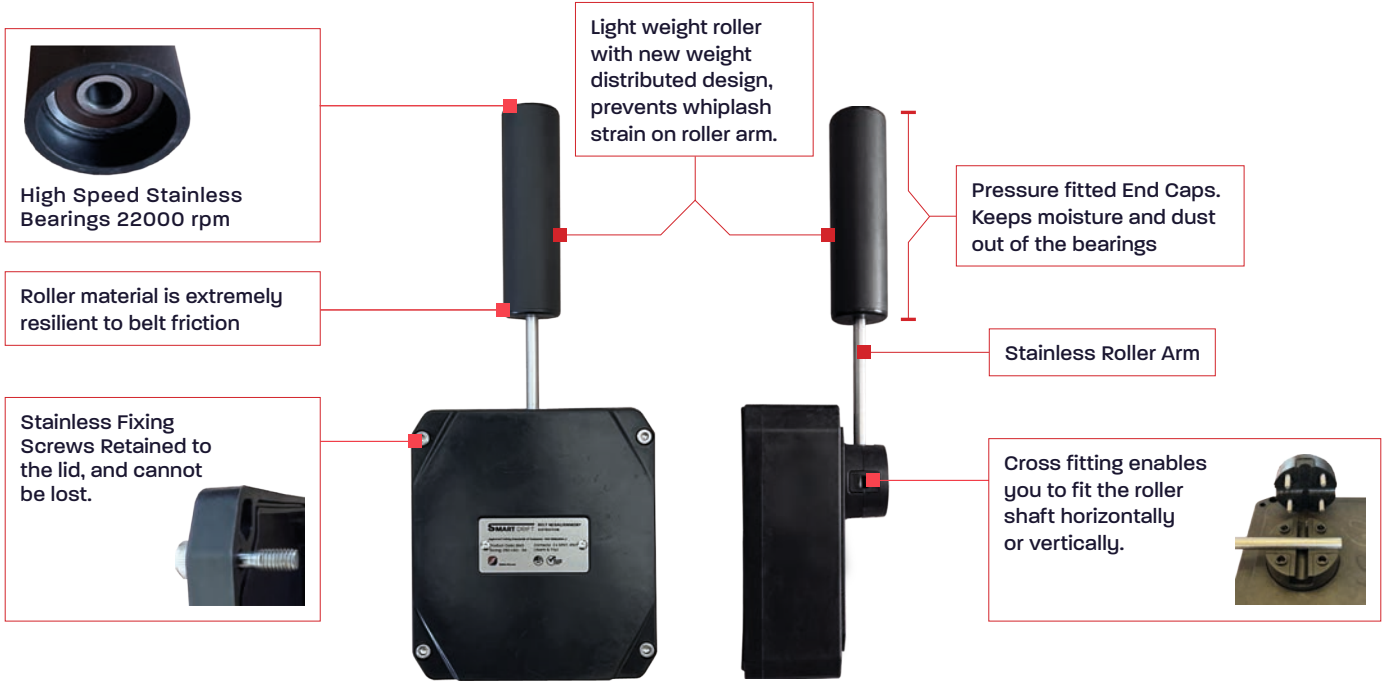

A CLOSER LOOK AT THE BM-3 ON THE INSIDE

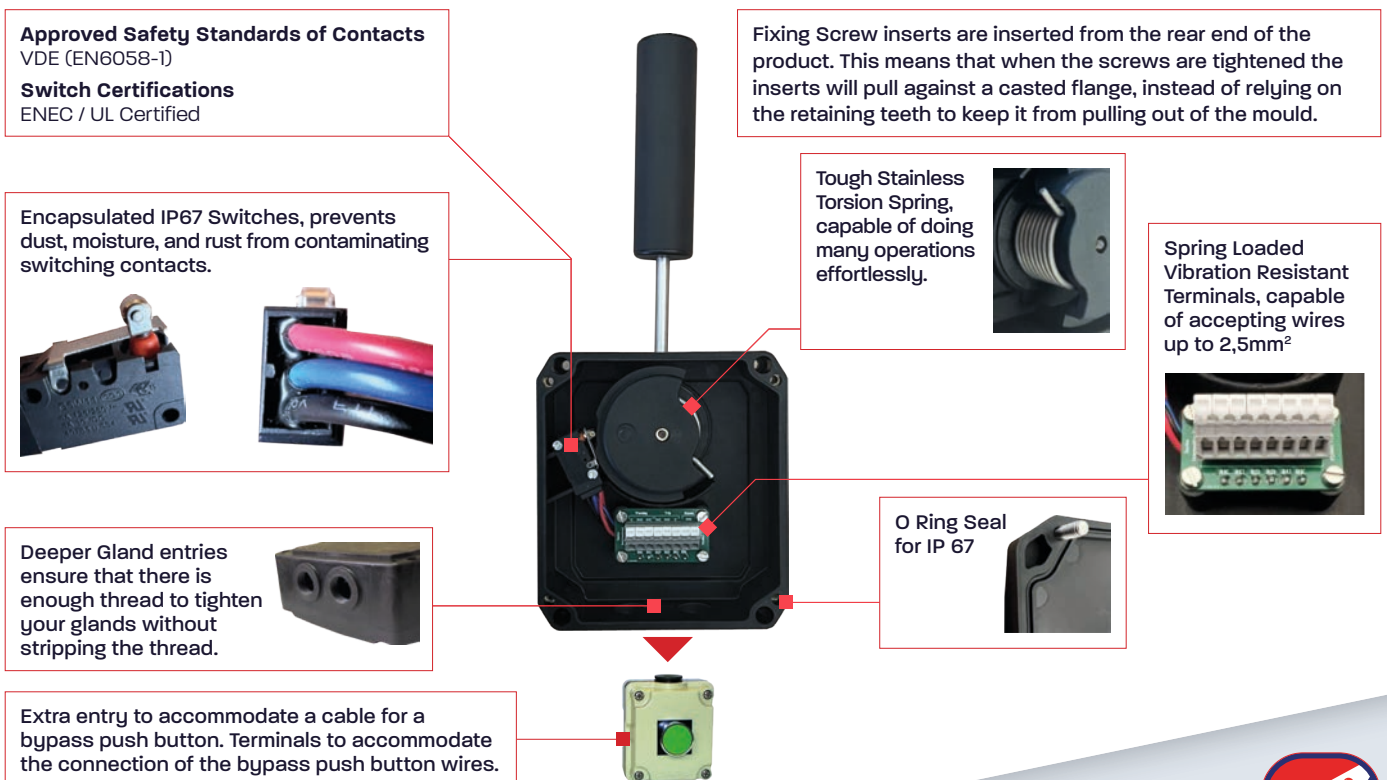

Belt Misalignment Detector BM-3 Smart Drift

A CLOSER LOOK AT HOW IT WORKS

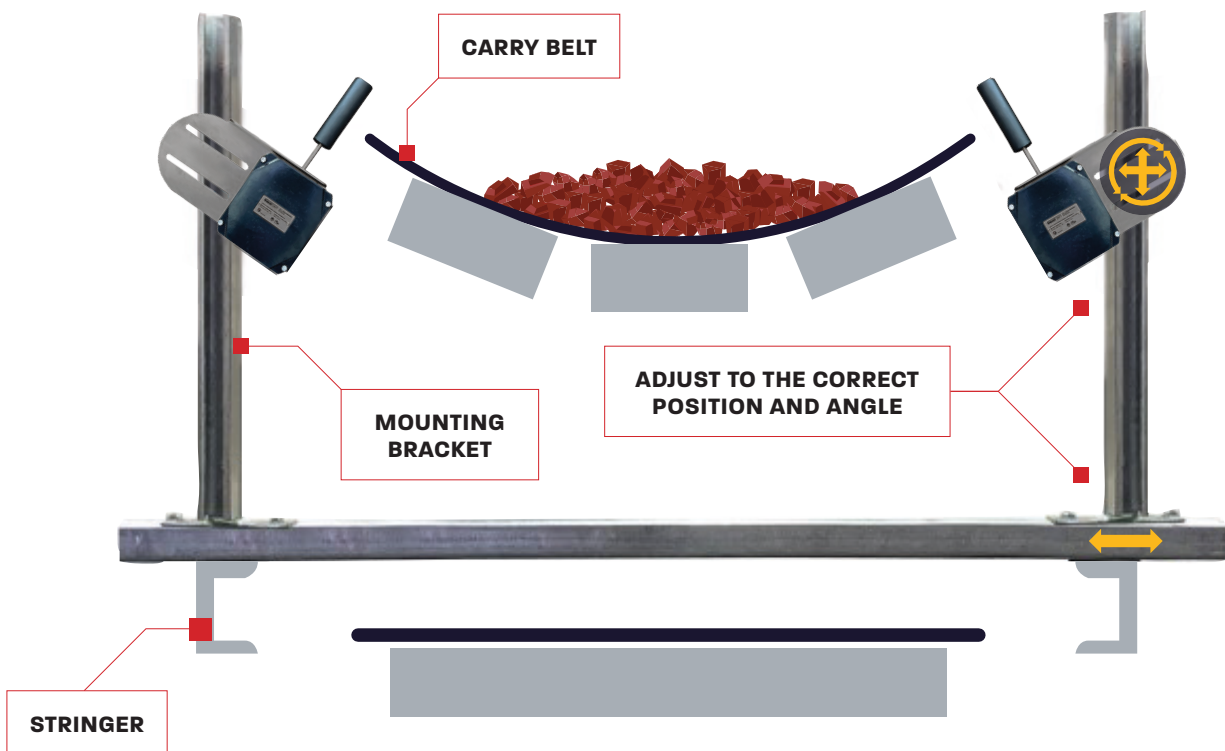

BM-3 TELESCOPIC MOUNTING BRACKET



As an optional extra, a BM-3 Telescopic Mounting Bracket can be purchased, with your BM-3 Belt Misalignment Switches. This mounting bracket is designed to cover all belt widths up to 2200mm. Wider assemblies are available on request.

BM-3 WIRING DIAGRAM

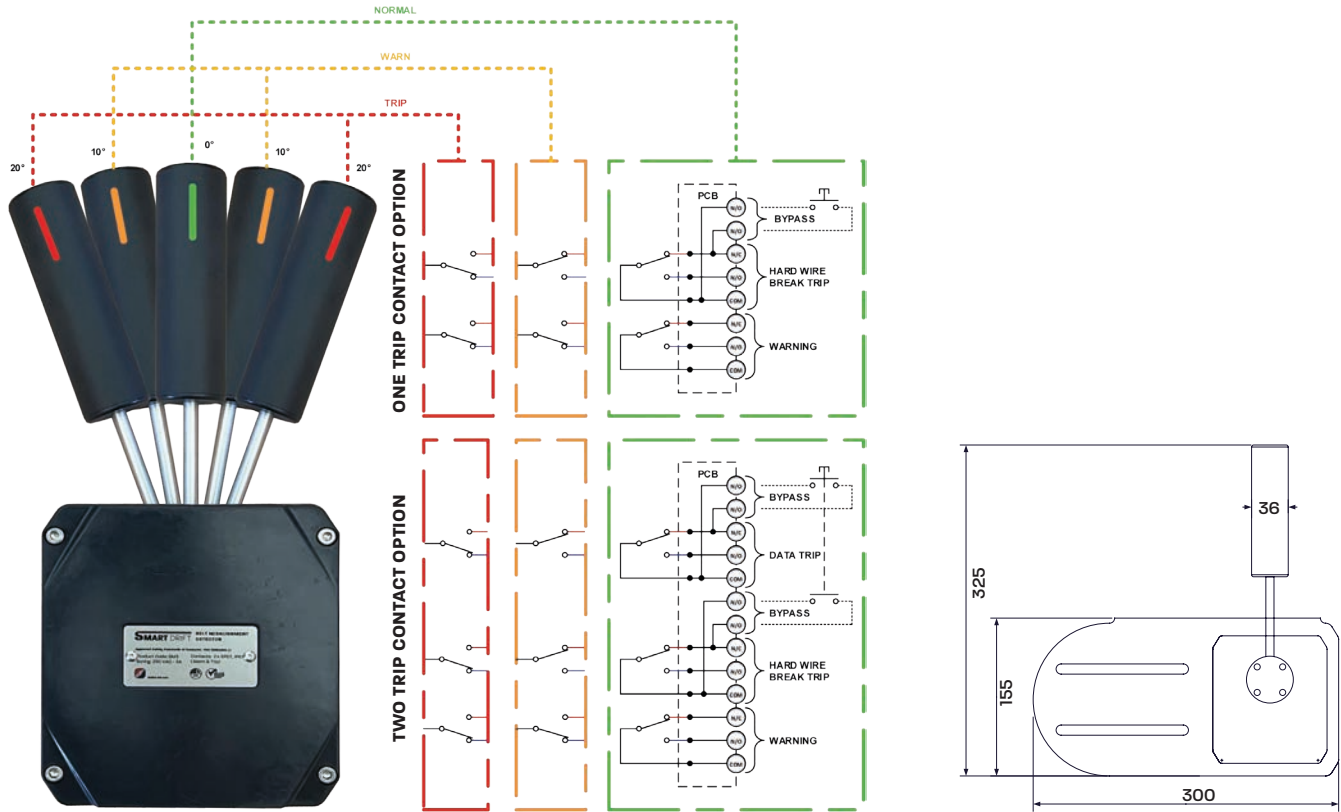

ORDERING DATA

Part Number	Description
S11819	BM-3 Smart Drift, with one trip & warn contact
S11820	BM-3 Smart Drift, with one trip & warn contact (Set of two)
S11821	BM-3 Smart Drift, with two trip & one warn contacts
S11822	BM-3 Smart Drift, 2 trip, 1 warn (Set)
S11743	BM-3 Telescopic Mounting Bracket, 2.2m, Stainless
S11744	BM2 Telescopic Mounting Bracket, 3m, Stainless
S11745	BM2 Telescopic Mounting Bracket, 2.2m, Galvanized
S11746	BM2 Telescopic Mounting Bracket, 3m, Galvanized
S11823	BM-3 Bypass Push Button Station